



FRAME INSTALLATION INSTRUCTIONS



(Note: For 3D visual reference only, the actual object shall prevail)

Caution: Due to the small screw sizes, please install manually.

Avoid using an electric screwdriver to prevent screw breakage caused by excessive torque.

3X

► Installation Preview

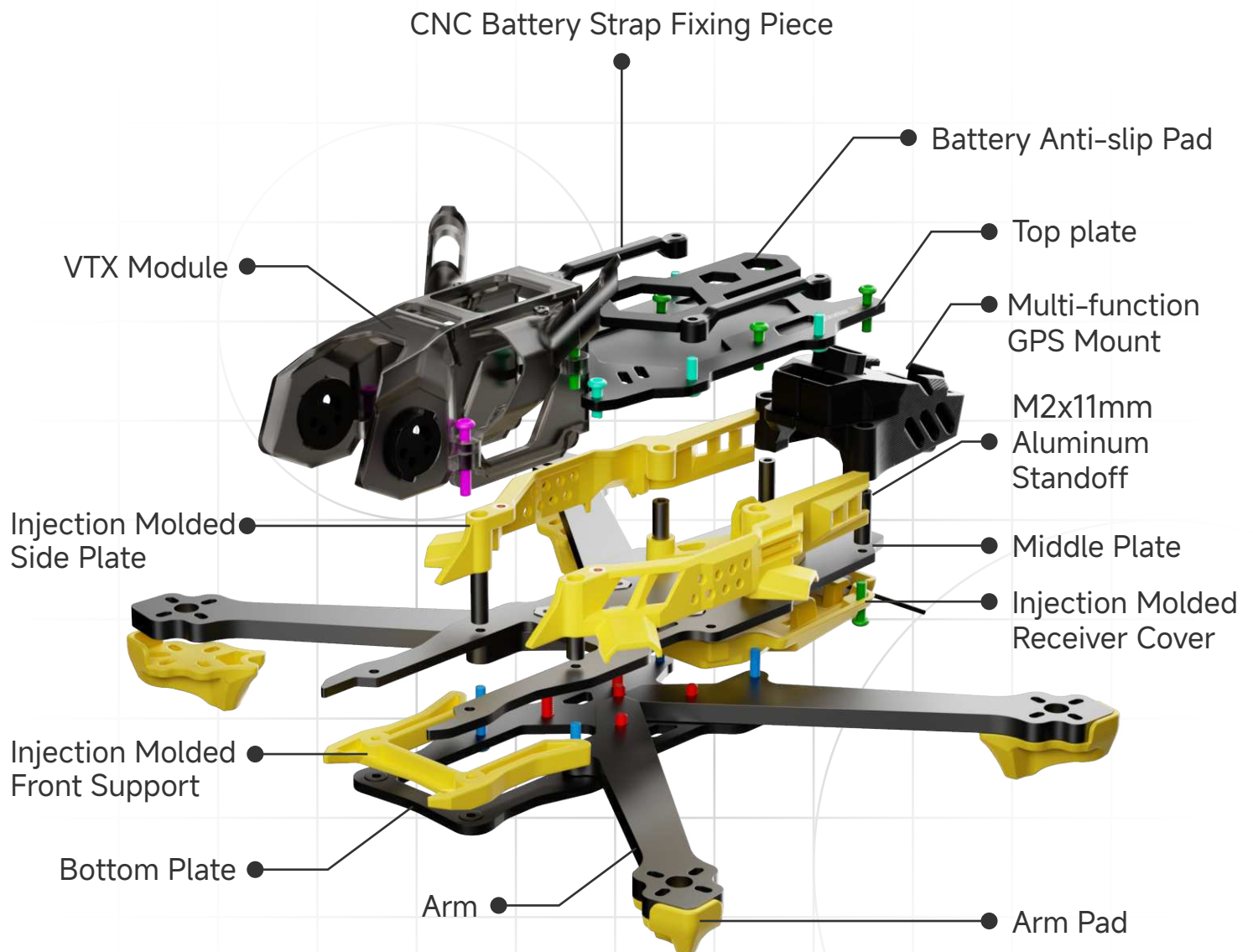

 M2×12mm
Button Head Hex
Socket Screw

 M2×13mm
Button Head Hex
Socket Screw

 M2.5×8mm
Button Head Hex
Socket Screw

 M2×8mm
Button Head Hex
Socket Screw

 M2×6mm
Button Head Hex
Socket Screw

► Arm Installation

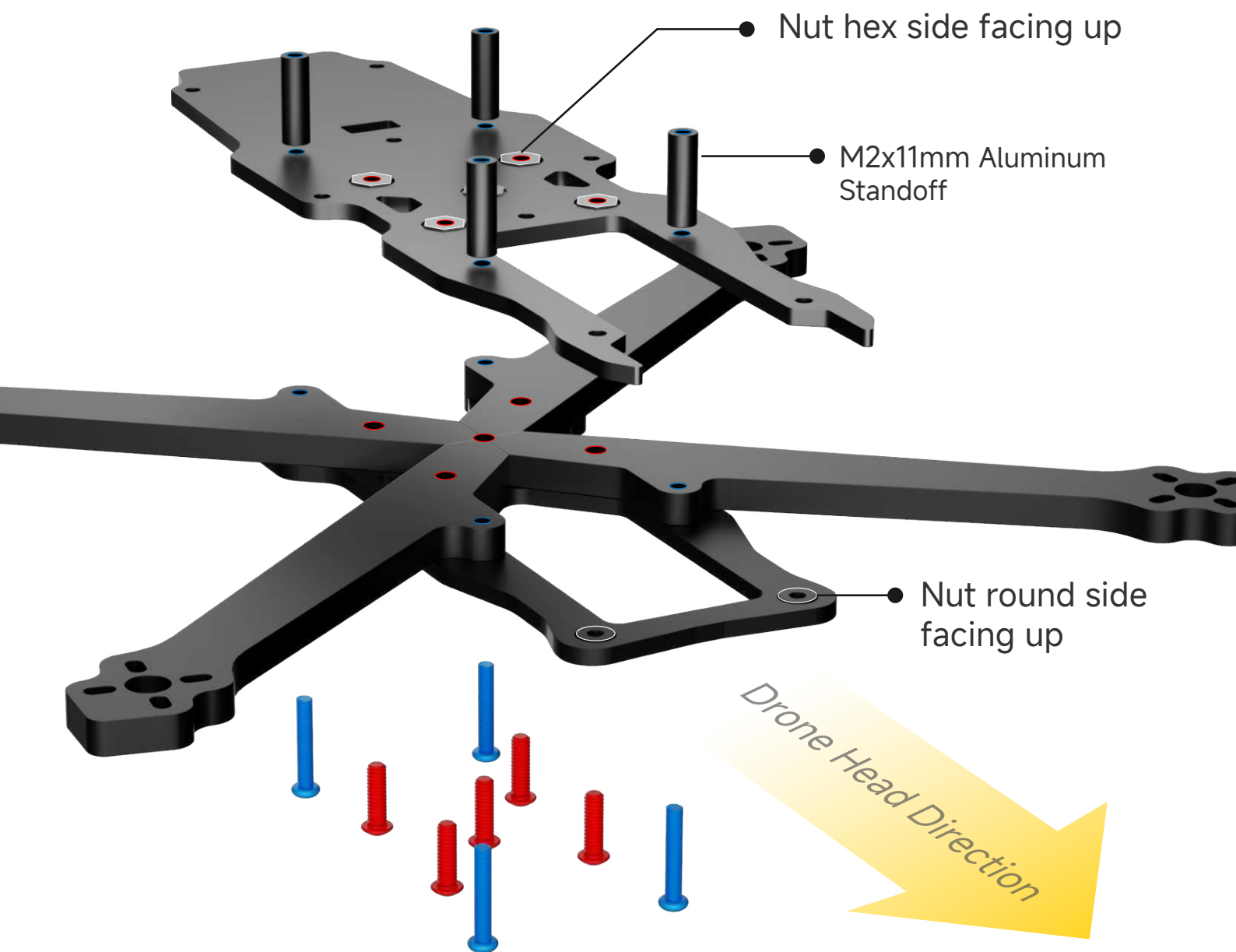

 M2.5×8mm
Button Head Hex
Socket Screw

 M2×12mm
Button Head Hex
Socket Screw

► Buzzer Injection Molded Part Installation

First, align the terminal with the opening on the middle plate. Then, install the buzzer injection molded part downward until it fits against the middle plate.

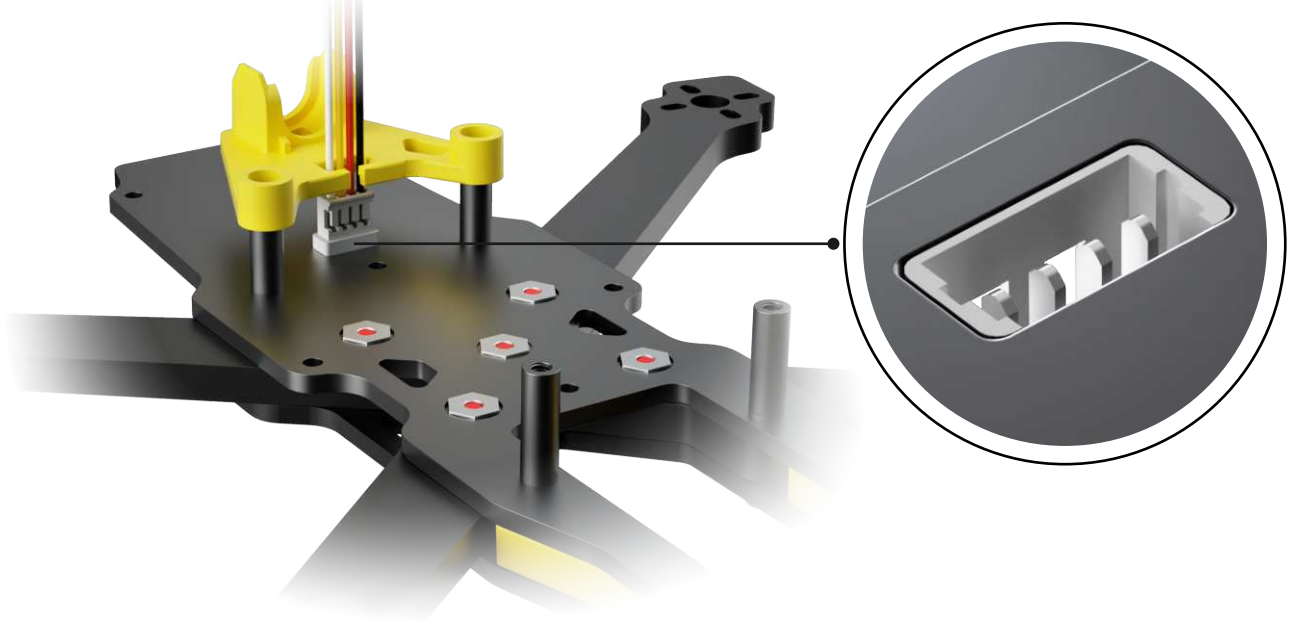

► Flight Controller Installation

Secure the flight controller in place using 4 **M2×12mm** button head hex socket screws and 4 M2 anti-slip nuts

Note: AIO is not included in the package.

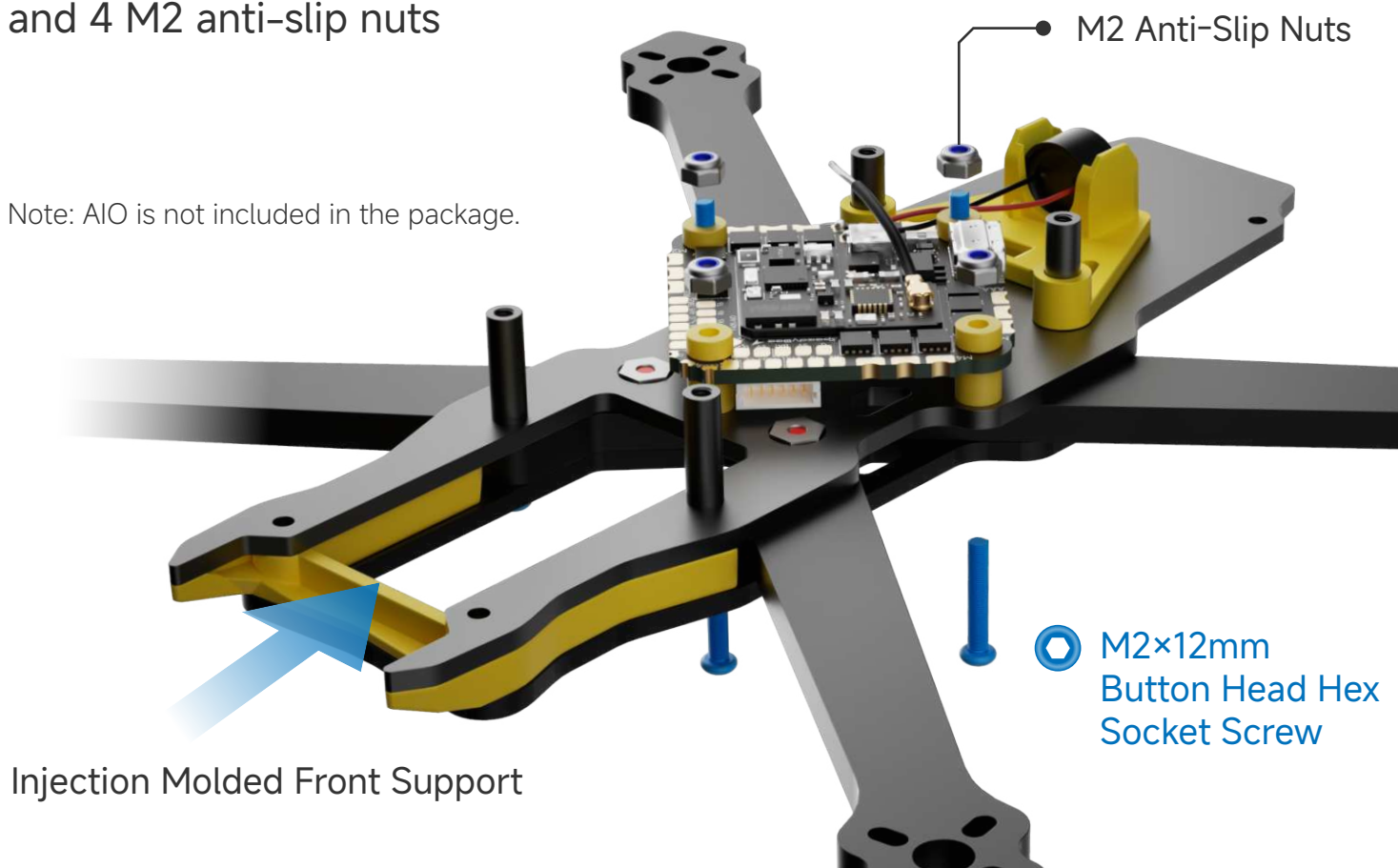

► Motor Installation



Note: Motors and motor wires are not included in the package

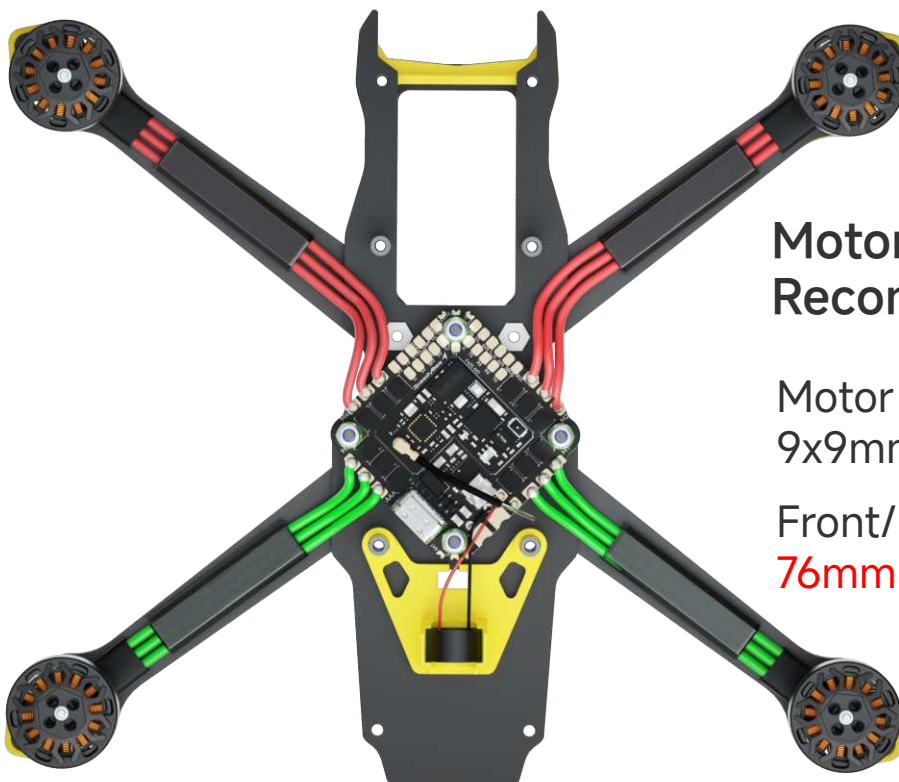
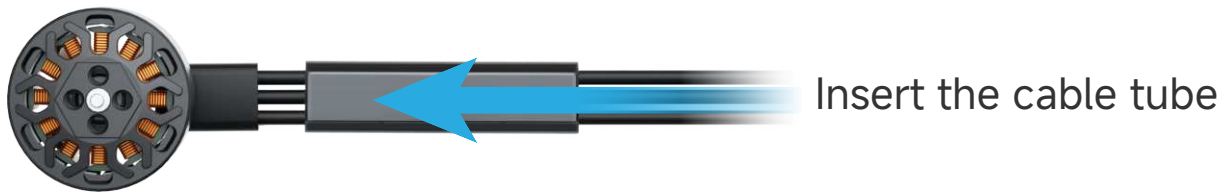

Motor Wiring and Recommended Cable Length

Motor Mounting Hole Spacing:
9x9mm, 12x12mm

Front/Rear Motor Wire Length:
76mm(Front) | 62mm(Rear)

► Strap Mounting

1. With the fuzzy side of the strap facing up, thread the aluminum alloy fixing piece through the strap.

2. Place the aluminum alloy fixing piece onto the upper carbon plate. Align the battery's adhesive side with the holes on both sides. Tighten the **M2x6mm** screws from the bottom upward.

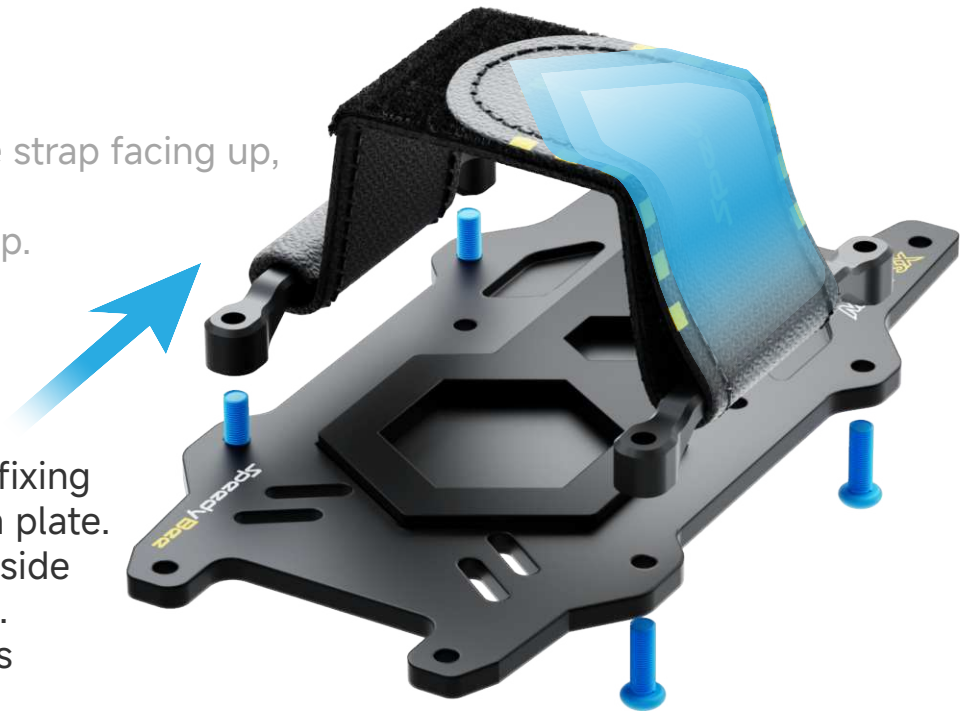

► Multi-function Tail Module Installation

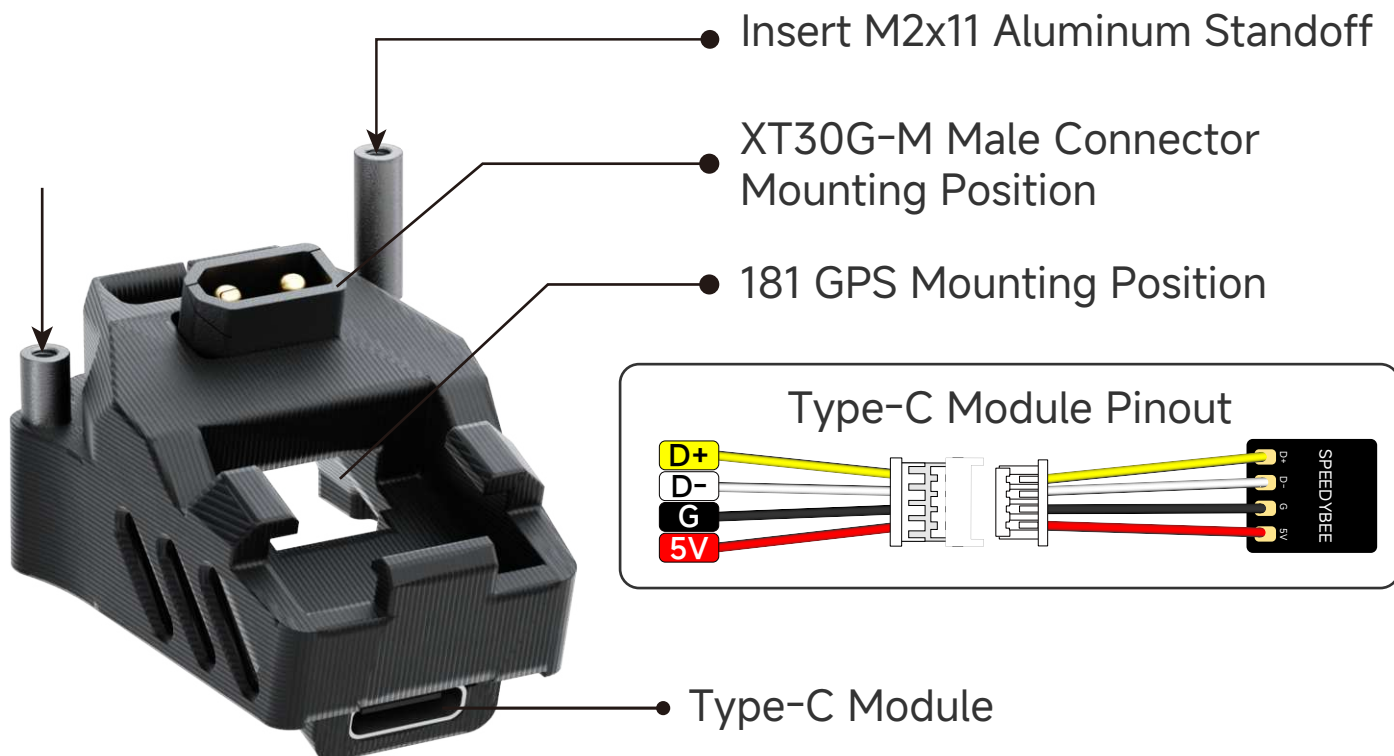

► Receiver, Multi-function GPS Mount, Side Plate Installation

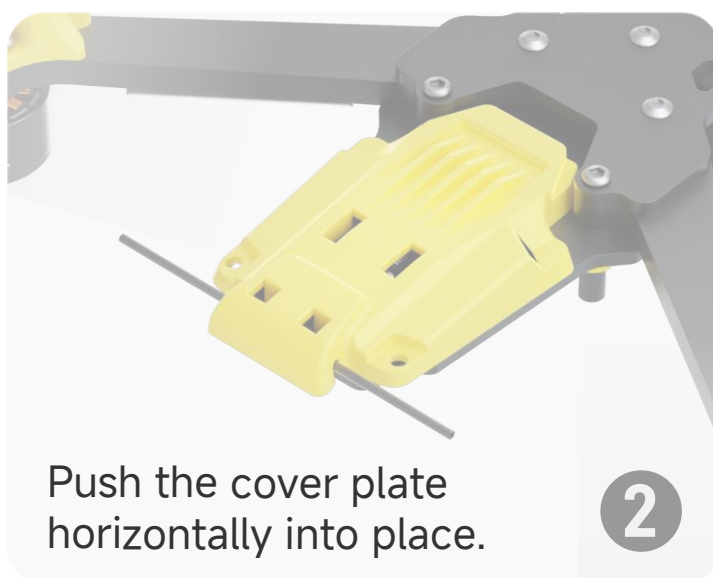

Note: Receiver is not included in the package.

Place the injection molded side plate onto the aluminum standoffs.

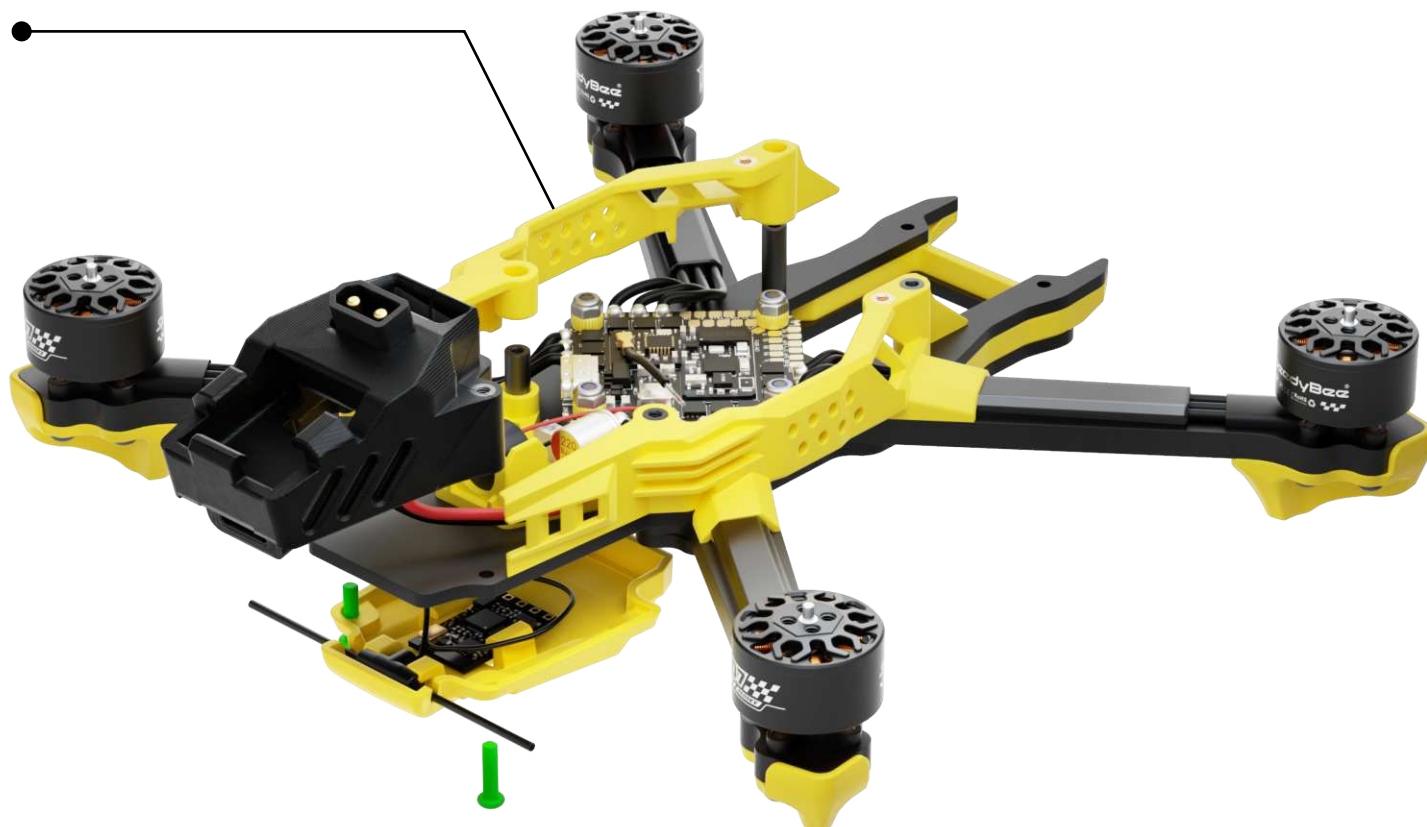

Secure the receiver cover plate using **M2x8mm** screws.

► Recommended Wiring

- Recommended Wiring for HD VTX
(Note: 6-Pin cable is not included in the package)



Try not to route cables over the top of the AIO.

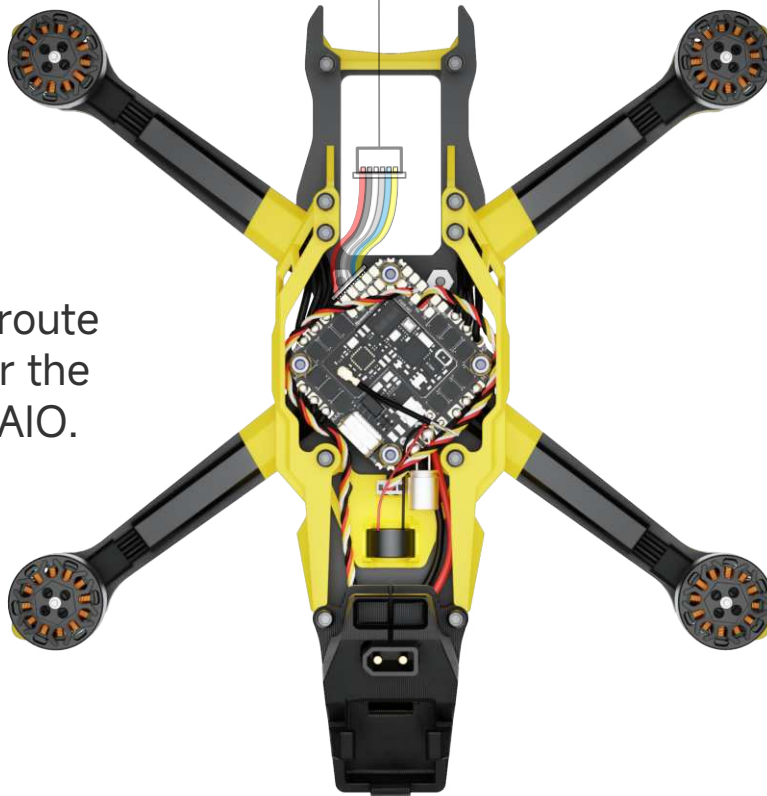

► Top Plate Installation

Place the top plate onto the injection molded side plate. Align the holes, and secure it using M2x8mm and M2x6mm screws.



M2×8mm
Button Head Hex
Socket Screw



M2×6mm
Button Head Hex
Socket Screw

► HD VTX Module Installation

● M2×13mm
Button Head Hex
Socket Screw

● M2×8mm
Button Head Hex
Socket Screw



Installation Tutorial for
O3 Aluminum Alloy Head

[Click to View](#)



Installation Tutorial for
O4 Pro Aluminum Alloy Head

[Click to View](#)

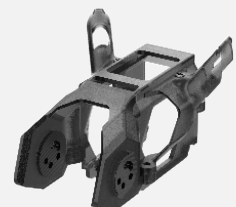

Installation Tutorial for
Injection Molded Head

[Click to View](#)

